

SOURCES

Olmsted Brothers. "Mr. R.B. Mellon, Pittsburgh, Pennsylvania. Plan of Property Showing Location of Existing Planting, Spring, 1931." File No. 6752, Plan No. 15.

1937 Aerial Photograph.

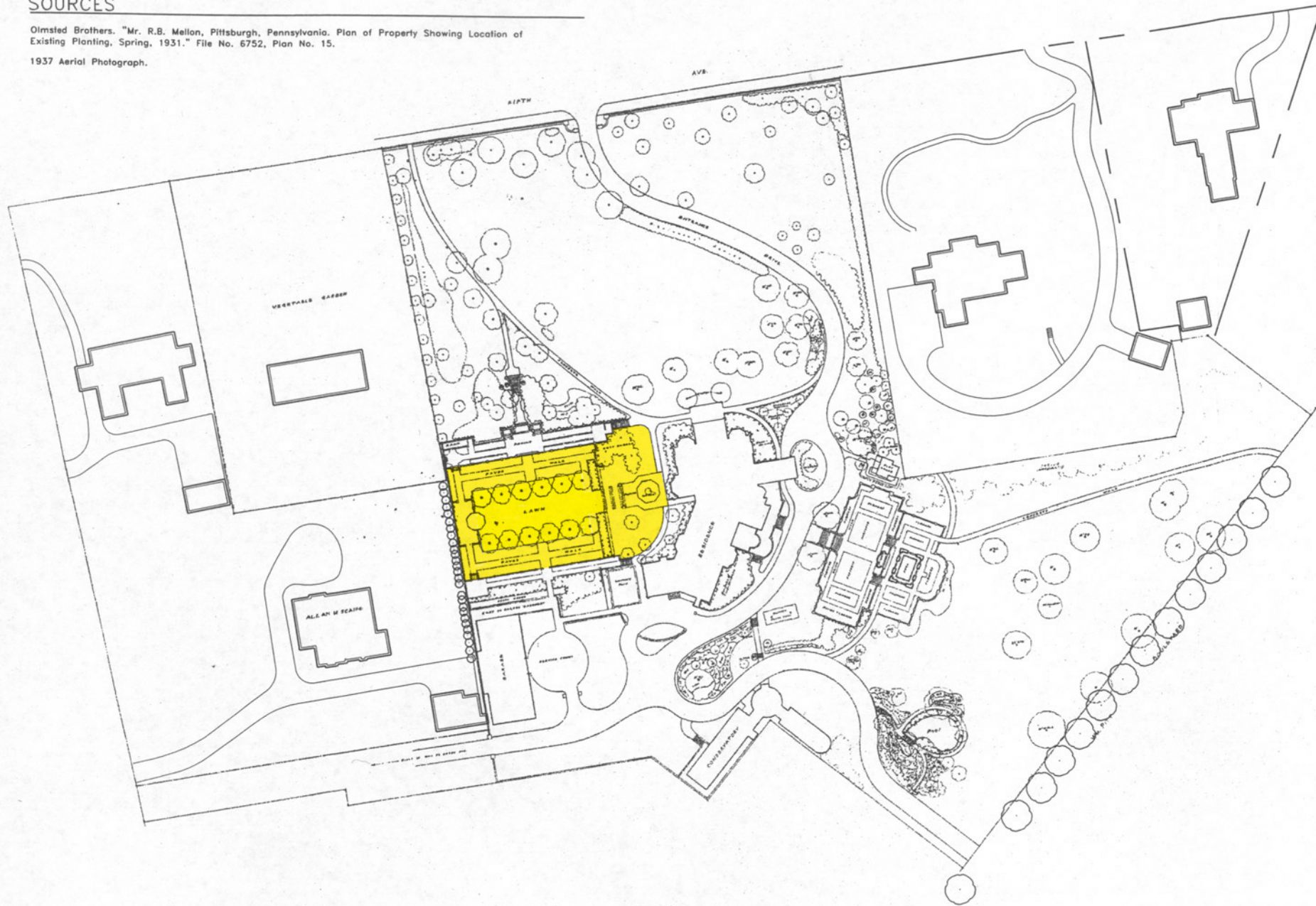

0 25' 50' 100'



MELLOM PARK Preservation & Management Plan Pittsburgh, Pennsylvania

Client:
Western
Pennsylvania
Conservancy
PO Box R
Mill Run, PA 15464

R.K. Mellon
Foundation
One Mellon Bank Center
500 Grant Street, #4106
Pittsburgh, PA 15219

Landscape Architect:
LANDSCAPES
LA • Planning • HP
501 Lake Road
Charlotte, VT 05445
(802) 425 4330

34 Wall Street
Norwalk, CT 06850
(203) 852-9966

Historian:
Barry Hannegon
Pittsburgh History &
Landmarks

Olmsted Historian:
Charles Beveridge
F.L. Olmsted Papers

Planning Consultants:
Mag Cheever
Pittsburgh Parks
Conservancy

Susan Rodemocher
Louisville Olmsted Parks
Conservancy

Tupper Thomas
Prospect Park Alliance

Drawing Title:
ESTATE
PERIOD
PLAN
c. 1930s

Drawing Number:
FIGURE II.4a